



Gyproc® FireStop



Gyproc® FireStop

Gyproc® FireStop board provides good fire protection owing to the unique behavior of the non-combustible gypsum core when subjected to high temperatures. The inclusion of fiberglass and other additives in the core of Gyproc® FireStop board improves its fire protective properties when compared with standard plasterboard. It is universally used in GypWall™ partitioning systems, wall linings and ceiling systems to give increased fire protection. Made from natural gypsum, Gyproc® FireStop board is manufactured with leading edge technology to meet international standards.

PRODUCT SPECIFICATION

- Thickness 12.5 mm, 12.7 mm
13 mm, 15 mm, 15.9 mm
- Edge Type Recessed Edge (RE) 
- Nominal Size 1200x2400 mm, 1220x2440 mm
(1220x1830 mm is available for 12.5 mm and 15 mm only)
- Density 745 - 755 kg/m³
- Appearance Front  Back 



S-P-01402



PERFORMANCE

- Fire Classification as Class O in accordance with UK Building regulations requirements
- 1-hour and 2-hour fire rating (GypWall™ system) in accordance to BS 476: Part 22, and ASTM E 119. Up to 4-hour fire rated assemblies in accordance to UL/cUL/ULC
- Non-combustible in accordance to BS 476: Part 4
- Low fire propagation in accordance to BS 476: Part 6 Index I
- Class 1 surface spread of flame in accordance to BS 476: Part 7
- Smoke Developed rating of O*

*For Type C only

HANDLING AND WORKABILITY

- Crack-free
- Seamless and smooth finishing

THERMAL INSULATION

- Thermal conductivity (λ) = 0.24 W/mk
- Thermal resistance (R) = 0.05 - 0.066 m² K/W*

*Depend on board thickness

STANDARDS

- BS EN 520 : 2004 + A1 : 2009
- ASTM C1396
- AS/NZ 2588
- UL Type C



GypWall™ System

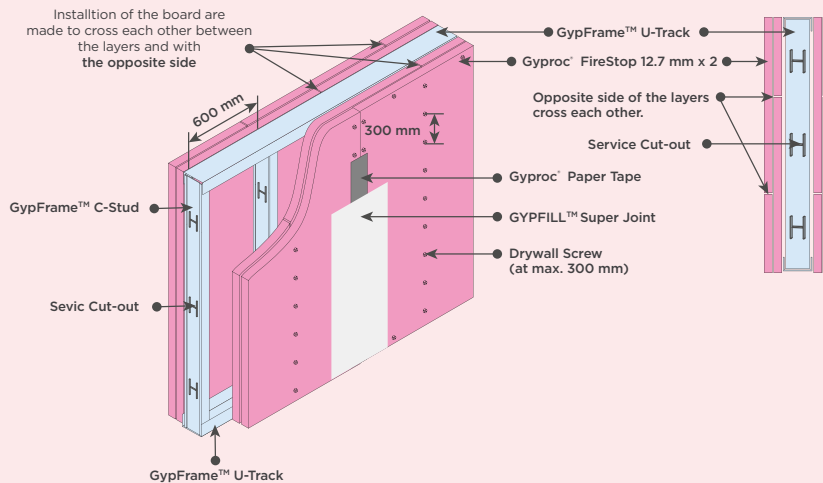

Example using 62 mm C-Stud and 64 mm U-Track.

Overall Width	Overall Weight	Fire rating (BS 476 Pt. 22)	Sound Insulation (R _w)	Max. Height	Partition Duty (BS 5234 Pt. 2)
122 ± 2 mm	48 kg/m ²	2 hours	48 dB*	4.4 m	Severe

*INGUL - predicting sound insulation software



Scan the QR Code to see other systems.

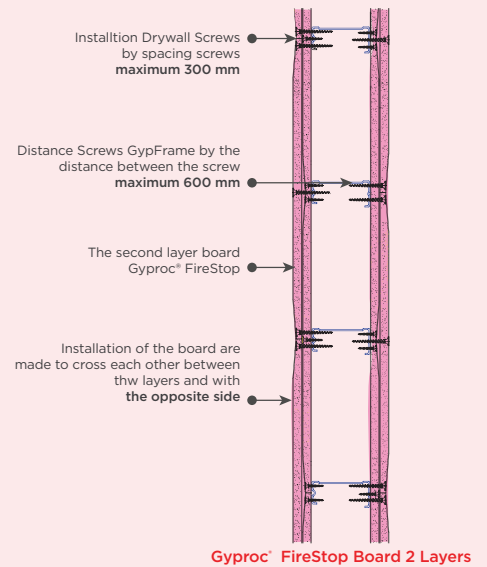

INSTALLTION INSTRUCTION



1 Determine and mark the wall position and make the allowance for openings. Fix U-Track Channel along centre line of floor and ceiling at 60, 61 cm centres with suitable fixings.



2 Cut C-Stud to the length according to the required wall height. Locate the cut C-Stud into U-Track Channel at 60, 61 cm centres (insert and twist to locate). In case designed lining wall is higher than normal height of gypsum board 2.40 m, additional U-Track Channel to support an infill panel is required.



3 Lift gypsum board 10 mm over the floor, fix 13 mm thickness Gyproc® FireStop board to all framing members at 30 cm centres using 25 mm drywall screws. Lightly butt boards, not closer than 10 mm from edge.



4 Finish board joints, hide screw heads and allow to set/dry. Remove imperfections ready for further decoration.

Services

Electrical and other services are normally installed after one side is boarded. Horizontal runs are routed through cut-outs in the stud. U-Track Channel can be installed between studs to support recessed switch boxes/socket outlets.

COMPONENTS USED IN GYPWALL™ SYSTEM



Gyproc® FireStop



GypFrame® C Stud

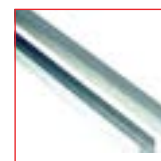

GypFrame® U Track



Expansion Bolts



Drywall Screw



Gyproc® Levelline



Gyproc® Jointing



Jointing Tape



Written enquiries should be addressed to:
Thai Gypsum Products Pcl.
Gypsum Metropolitan Tower
539/2 Si Ayutthaya Road,
Thanon Phayathai, Ratchathewi,
Bangkok 10400 Thailand

Technical Support
E-mail : tboc.gyprocthailand@saint-gobain.com

Customer Service Centre
E-mail : csc.tgp@saint-gobain.com

Version : August 2023



saint-gobain.co.th



Saint-Gobain Thailand